



COATINGS FOR CARPENTRY

Smart protection of wooden structures

COATINGS FOR CARPENTRY

Are you a **carpenter** working on a softwood loft?

Are you an **architect** dealing with a building system based on natural materials?

Do you produce big wooden structures in the field of **industrial carpentry**?

Are you going to participate in a **public tender**?

If the answer to even one of these questions is yes, we strongly advise you to protect the outcome of your hard work with highly protective coatings, complying with European standard UNI EN 335.

Softwood woodworks will resist to biological threats, thanks to the protection of Renner Italia water-based primers. Our products, based on top-notch technology, are effective in just a few extraordinarily highly performant coats and make fir wood compliant with class 3 risk (UNI EN 335).

These water-based products

- protect from the attack of blue staining fungi and rot
- prevent from and remedy for the aggression of fungi, woodworms and termites

They are the reliable allies for those who want to take advantage of versatile, efficient, long-lasting, compliant with standard and aesthetically advanced claddings.





Carpentry and its problem-solving coating-solution

In a field where process speed and natural aesthetic result are two essential distinguishing features, a good coating system must:

- 1. increase the level of protection of wood**
- 2. obviate the weaknesses of the raw material**
- 3. last for a long time**
- 4. reach the previous three goals with a few products and very few coats**

Renner Italia water-based products definitely solve carpentry problems while turning them into actual points of strength to satisfy the end user and ensure the competitive advantage in a more and more complex market.

Fir

Forget flaws

with hi-tech coatings

Among the wood species mostly used in carpentry, fir plays a leading role. Fir is a fundamental building material, thanks to its performance and beauty features.

However, it can't withstand outdoor conditions on his own.

Moreover, it is subject to the attack of fungi, moulds and woodboring insects, just like most of timbers. These risk factors jeopardize its stability.

Finally, the widespread use of younger and less seasoned fir is nowadays showing increased silvering problems (greying of the wooden pore). An aesthetic flaw often generating clients' complaints.

Thanks to Renner Italia water-based primers, wood stains and topcoats, fir stops being a problem, and starts being only a source of satisfaction for every customer.

PARTICIPATE IN ITT

complying with Minimum Environmental Criteria

The wood is exposed to several risk factors. The different types have various durability features. UNI EN 335 standard draws up five different Use Classes of wood and defines the right treatment for each one of them. Renner Italia coatings for carpentry comply with standard UNI EN 335 to allow fir wood to reach Use Class 3.

Taking advantage of the compliance with the standard of our range offers to the carpentry professional the possibility to participate in invitations to tender for the realization of public and private structures with the right equipment.

Use Class 1

The wood is sheltered and not directly exposed to atmospheric agents and humidity.

Woodworks: furniture, wood floorings, matchboards, etc.

Use Class 2

The wood is sheltered and not directly exposed to atmospheric agents, but placed inside areas with a high level of humidity, which can cause random humidification (not persistent).

Woodworks: beams, ceilings, outdoor doors and windows, outdoor claddings, street furniture etc.

Use Class 3

The wood isn't sheltered and not in contact with the ground. It is continuously exposed to atmospheric agents or it is sheltered from atmospheric agents, but it is subject to persistent humidification.

Woodworks: poles, fences, pool edges, outdoor doors and windows, outdoor claddings, street furniture etc.

Use Class 4

The wood is in contact with the ground or with freshwater. It is continuously exposed to humidification.

Woodworks: poles, fences, pool edges, river banks, street furniture etc.

Use Class 5

The wood is continuously exposed to saltwater.

Woodworks: poles, piers, mooring poles etc.

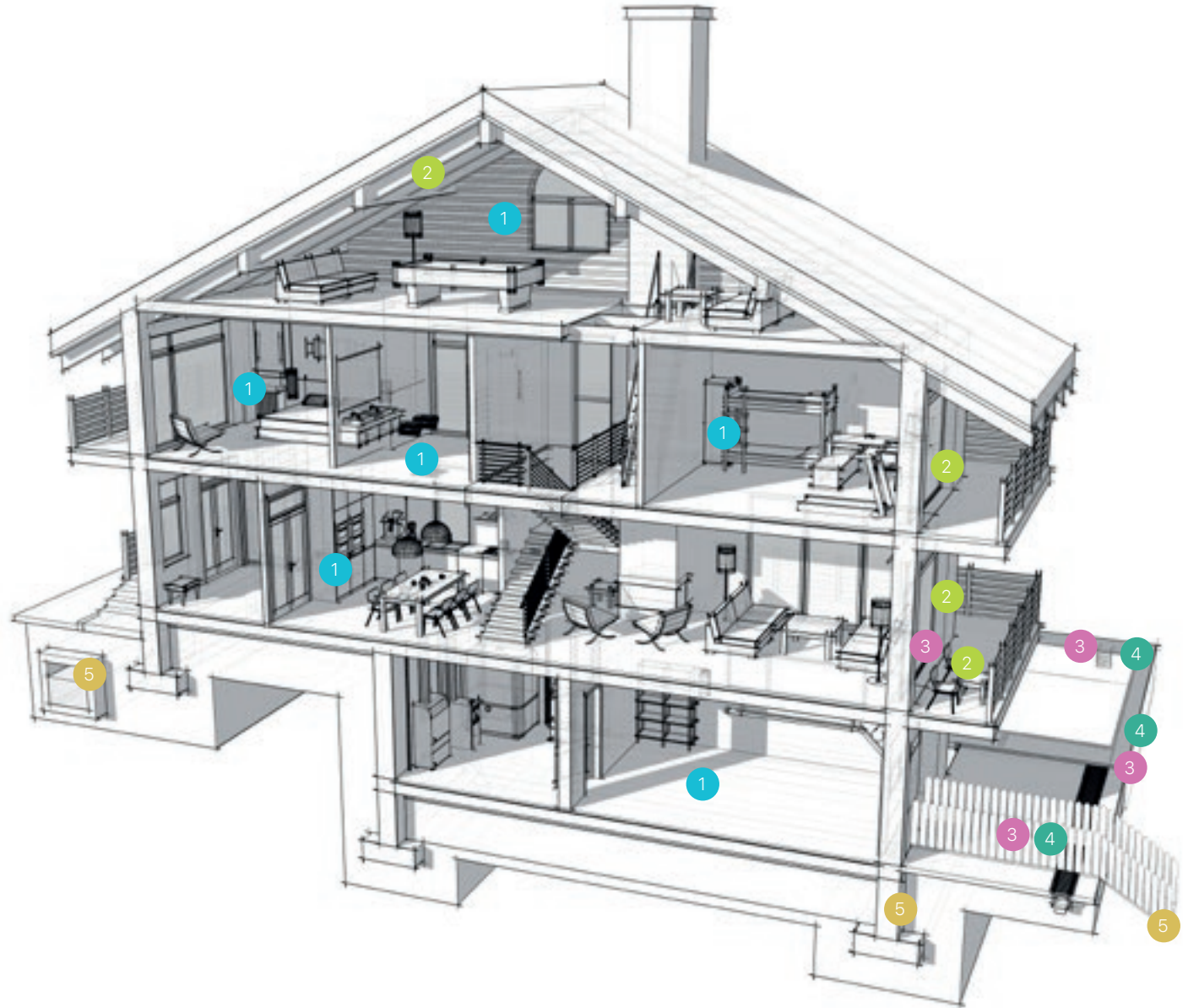



TRANSPARENT, WHITE AND PASTEL FOLLOW THE DESIGN COATINGS

High versatility makes coatings for carpentry of Renner Italia stand out

Generally, structural elements are required a natural aesthetic look, such as sub-roof beams, wall claddings and pillars. In other words, almost always highlighting wood grains and knots is the chosen solution. However, there are those who want to customize those surfaces with white and pastel shades, interpreting color design in more and more articulate experimentations. Anyway, Renner Italia color chart is wide, in line with the trends of the moment and respectful of classic tastes of tradition.



LESS EMISSIONS

More responsible More sustainable

The carpentry product range was studied not only to offer great performances in terms of resistance and design, but also to give a contribution of environmental sustainability to manufacturing and craftsmanship.

These products are boosted with the most advanced technologies aimed at preserving the environment. We comply with the Minimum Environmental Criteria, also identified as CAM 2017 Decree of Italian Ministry of Ecological Transition and UNI EN ISO 16000 standard. Some specific coatings are certified as A+ for indoor air emissions.

Renner Italia coatings aim at

- reducing carbon dioxide emissions
- reducing petroleum derivatives
- using raw materials from recycling processes
- improving indoor air quality
- creating healthier and more livable places
- reducing natural resources consumption
- eliminating wastes

APPLICATION BENEFITS

Production requirements need smart coatings, with remarkable yield, even if applied in single coats.

GREAT QUALITY/SOLID CONTENT COMPARISON

CLEAR WOOD STAIN – YM M134

Low indoor emissions and low solid content wood stain. Limited silvering around the knot of the softwood. Ultra-fast drying. Stackable in a few hours.



Application	Impregnating machines	Brush	Roller	Pad	Spray gun
-------------	-----------------------	-------	--------	-----	-----------

GREAT HIDING POWER/CHEMICAL PERFORMANCES COMPARISON

PIGMENTED WHITE WOOD STAIN – YM M216/--C02

Low indoor emissions and high hiding power wood stain. It isolates the knot, avoiding yellowing. Fast drying. Stackable in a few hours.

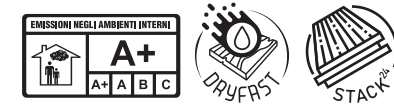

Application	Impregnating machines	Brush	Roller	Pad	Spray gun
-------------	-----------------------	-------	--------	-----	-----------

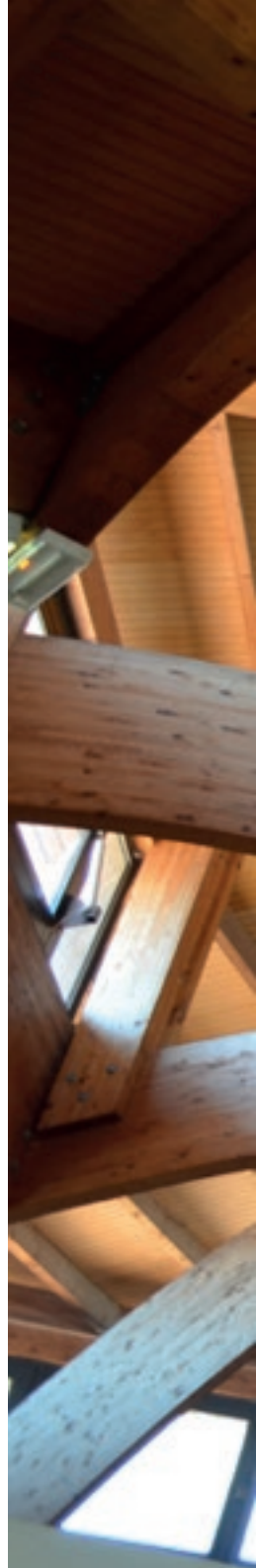





ESTHETIC NEEDS

The shininess of the grain and the elimination of grey effects (caused by different absorption) are the most important needs in terms of structure design.

BRIGHTENER

CLEAR WOOD STAIN – YM S035

Semi-gel with high solids content with great application and durability features. Its capability of brightening the wood makes it stand out.



Application	Impregnating machines	Brush	Roller	Pad	Spray gun
--------------------	-----------------------	-------	--------	-----	-----------

HIGH-GLOSS TOPCOAT EFFECT

CLEAR WOOD STAIN-TOPCOAT – YL C158/--NTR

High solids content. The best shininess on the knots. To be pigmented.



Application	Impregnating machines	Brush	Roller	Pad	Spray gun
--------------------	-----------------------	-------	--------	-----	-----------

WHITENED NATURAL EFFECT

WHITE SEMI-TRANSPARENT WOOD STAIN – YM C215/--C02

Product that follows the latest trends in terms of design, thanks to its semi-covering power.



Application	Impregnating machines	Brush	Roller	Pad	Spray gun
--------------------	-----------------------	-------	--------	-----	-----------

MATT COVERING EFFECT

WHITE WOOD STAIN WITH HIGH COVERING POWER – YM C236/--C02

The product for those looking for an aesthetic effect similar to the pigmented system.



Application	Impregnating machines	Brush	Roller	Pad	Spray gun
--------------------	-----------------------	-------	--------	-----	-----------

DURABILITY RESISTANT TO BIOLOGICAL AGENTS

To extend the life of carpentry woodworks, it is suggested to use preservative primers.
This is mandatory for softwoods to reach Use Class 3 of UNI EN 335.

PRESERVATIVE BIOCIDES PRIMER – YM M101

Top Quality primer, which prevents the attack of blue staining and wood-rotting fungi.
Registered as a biocide according to BPR Regulation EU 528/2012.
Authorization number for Italy (PT 8): IT/2020/00691.



Application	Impregnating machines	Brush	Roller	Pad	Spray Gun	Dipping	Flow coating
-------------	-----------------------	-------	--------	-----	-----------	---------	--------------

PRESERVATIVE BIOCIDES AND INSECTICIDES PRIMER – YM M104

Top Quality primer, which prevents from and remedies for the attack of blue staining and wood-rotting fungi and the aggression of woodboring insects, such as woodworms and termites.
Registered as a biocide according to BPR Regulation EU 528/2012.



Application	Impregnating machines	Brush	Roller	Pad	Spray Gun	Dipping	Flow coating
-------------	-----------------------	-------	--------	-----	-----------	---------	--------------





DURABILITY SELF-CONSUMING TECHNOLOGY

Hydro-oils, in addition to their high-level anti-degradation performances, do not need sanding during maintenance.

HIGH-ABSORPTION HYDRO-OIL – YS C100/--NTR

Top Quality product, self-consuming and with harmonizing effect. It boasts high concentration of free radical scavengers, UV and IPBC absorbers. To be pigmented.



Application	Impregnating machines	Brush	Roller	Pad	Dipping	Flow coating
--------------------	-----------------------	-------	--------	-----	---------	--------------

SELF-SEALER HYDRO-OIL – YS M305

Top Quality product with high solids content. It is self-consuming. It boasts high concentration of free radical scavengers, UV and IPBC absorbers. To be pigmented.



Application	Brush	Roller	Pad	Spray gun
--------------------	-------	--------	-----	-----------



Via Ronchi Inferiore, 34 - 40061 Minerbio (BO) Italia
T. +39 051 6618 211 F. +39 051 6606 312
www.renneritalia.com - info@renneritalia.com

